

CAUTION

When pumping chemicals make certain that all tubing is securely attached to the fittings. It is recommended that tubing or pipe lines be shielded to prevent possible injury in case of rupture or accidental damage. Always wear protective clothing when working on or near chemical metering pumps.

NUMBER FM LIQUID HANDLING ASSEMBLY

CONNECTING DISCHARGE PIPE

Note: corrosion resistant, $\frac{1}{4}$ " Schedule 80 pipe should be used. Do not use $\frac{1}{8}$ " pipe.

1. Discharge valve has $\frac{1}{4}$ " NPT male outlet. A $\frac{1}{4}$ " union should be connected to both discharge and suction valves so that chemical metering pump may be removed without disturbing piping.

It is recommended that Teflon tape be used on tapered pipe threads so that there is a leakproof seal without overtightening of fittings.

CONNECTING SUCTION PIPE

1. Using the same size and material pipe as used on discharge line, cut suction pipe to required length.
2. Use of Teflon tape on tapered pipe threads is again highly recommended, to be sure connections are leakproof.

Suction side leaks are invisible but if a leak is present pump will suck in air during each suction stroke.

3. Maximum recommended vertical suction lift is 5 ft. (1.5 m).

PRIMING

1. Temporarily loosen the union on top of discharge valve.
2. Set pump at near maximum (80%) speed and 100% stroke and start pump. CAUTION: "B" and "C" series stroke cannot be adjusted until pump is operating electrically. Push and turn lower knob while unit is stroking.
3. As soon as chemical begins to leak at the union on top of discharge valve, stop the pump.
4. The pump is now primed.
5. Tighten union on top of discharge valve.

PARTS LIST

Ref. No.	Part No.	Description	Quantity
3	10338*	Ball, Ceramic	3
4	10107*	Seal Ring, Hypalon, green dot	3
5	10492-1	Valve Seat, gray PVC	1
8	10493-1	Valve Housing, gray PVC	2
9	10213	Head, gray, PVC	1
10	10302*	Liquifram, 0.9 SI Teflon Face	1
11	10340	Screw, 10-24x $\frac{1}{4}$ S.S.	4
13	10978	Foot Valve Seat, Polypropylene	1
14	10123	Strainer, white Polypropylene	1
16	10891	Discharge Valve Assembly	1
17	10892	Suction Valve Assembly	1
18	10893	Foot Valve Assembly	1
19	10890	Head Assembly	1

*PARTS INCLUDED IN
SPARE PARTS KIT NO. **SP - FM**

Specifications subject to change without notice.



LIQUID METRONICS INCORPORATED

3 JONES ROAD, WALTHAM, MASS. 02154 USA
(617) 891-0690 TLX 92-3478

Printed in U.S.A.

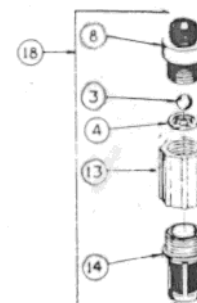
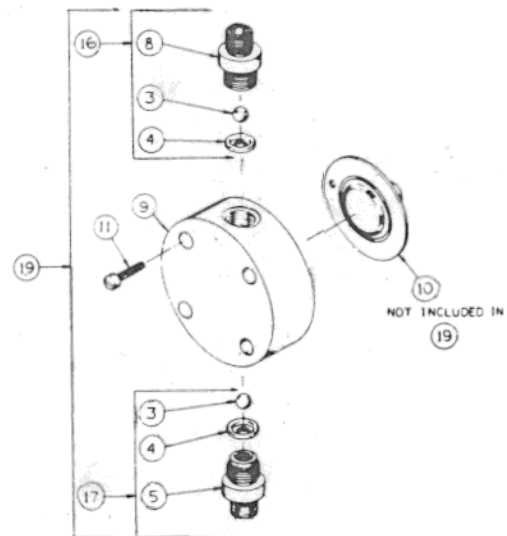

1087A
1C1278
replaces
1087