

LIQUID HANDLING ASSEMBLIES — Z SERIES METERING PUMPS

LE 05 SERIES

Ref. No.	Part No.	Description	Quantity			
			LE-05	LE-05E	LE-05S	LE-05SE
1	10294	Injector Fitting	0	1	0	1
2	10339	Spring	0	1	0	1
3	10338	Ball, Ceramic	2	4	3	4
4	10307	Seal Ring, Fluorosilicone	2	4	3	4
5	10292	Valve Seat	1	2	1	2
6	10299	Coupling Nut	2	4	3	4
7	10342-16	Tubing	0	1	1	1
8	10293	Valve Housing	1	2	1	1
9	25960	Head	1	1	1	1
10	26041	Liquifram	1	1	1	1
11	10340	Screw, S.S.	4	4	4	4
12	10322	Weight, Ceramic	0	1	1	1
13	10978	Foot Valve Seat	0	1	1	1
14	10123	Strainer	0	1	1	1
15	10684	Injection Check/Back Pressure Valve	0	1	0	1
16	10685	Discharge Valve Ass'y	1	1	0	0
17	10686	Suction Valve Ass'y	1	1	1	1
18	25048	Foot Valve Ass'y	0	1	1	1
19	26413	Head Ass'y	1	1	0	0
19	26513	Head Ass'y	0	0	1	1
21	25690	Anti-Syphon/Pressure Release Ass'y	0	0	1	1
22	25691	Relief Cap Ass'y	0	0	1	1
23	25692	Anti-Syphon Cap Ass'y	0	0	1	1
24	25672	Screw	0	0	4	4
25	25449	Coupling Nut, Flapper	0	0	0	0
26	10290	Flapper, Viton	0	0	0	0
27	10294	Injector Fitting	0	1	0	1
35	25369	Valve Body	0	0	1	1
36	25628	Nut, S.S.	0	0	4	4
37	25631	Nut, Ferrule	0	0	1	1
38	25636-03	Tubing, Polyethylene, .25" O.D.	0	0	1	1
41	26136	Clamp Ring	2	3	2	3

*For Spare Parts Kit order Part No. SP-05.

1. Maximum pump pressure rating is reduced by 25 psi (1.7 bar) with anti-syphon spring installed.
2. Do not remove anti-syphon spring if pressure at injection point is less than 15 psi (1.0 bar).

NOTE: Threaded connections into pump head are 3/4"-16 straight threads. Do not use Teflon tape. These joints are sealed by seal ring valve seats (Item 4 on exploded view).

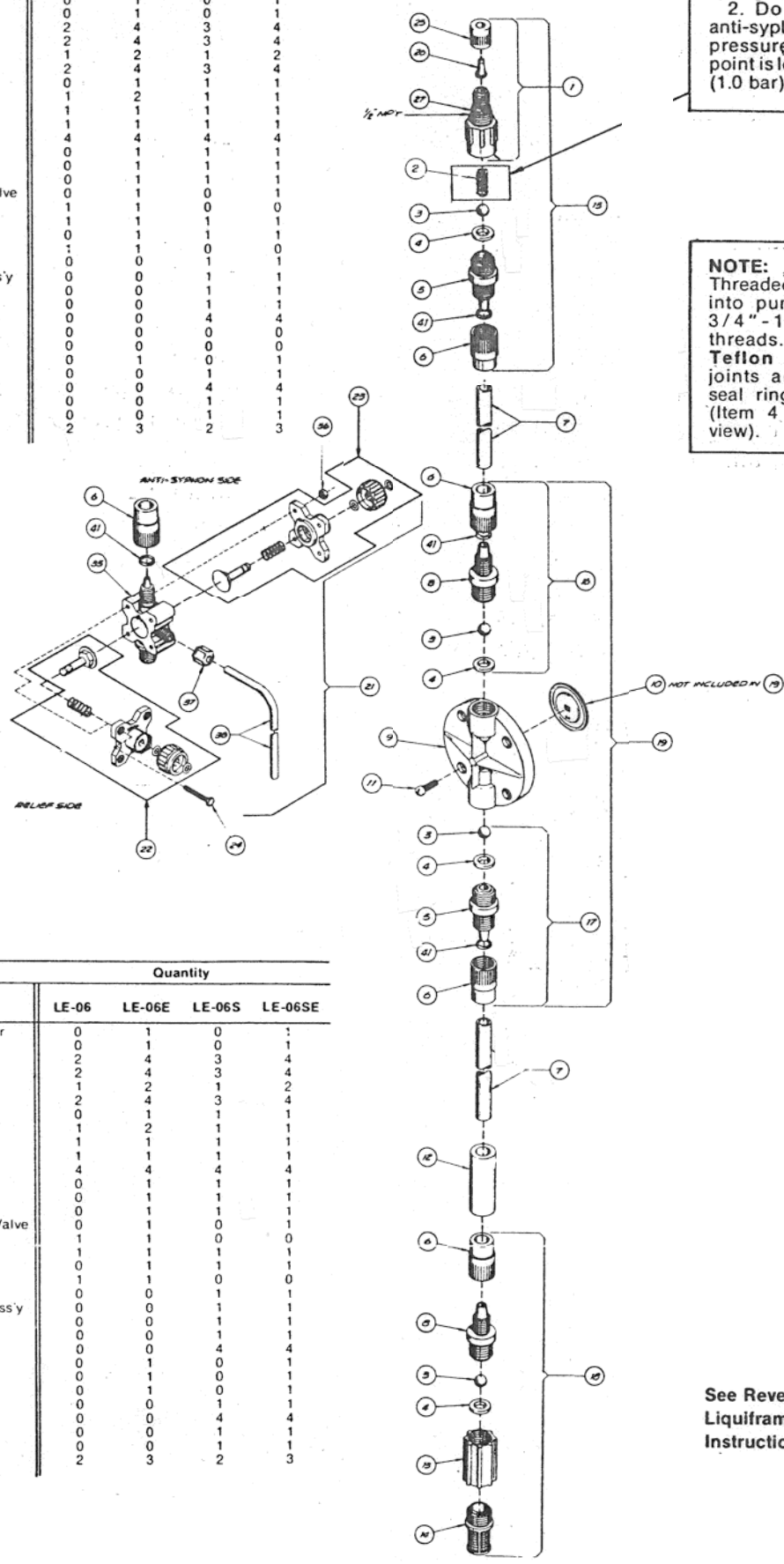

LE 06 SERIES

Ref. No.	Part No.	Description	Quantity			
			LE-06	LE-06E	LE-06S	LE-06SE
1	10297	Injector Fitting with Viton Flapper	0	1	0	1
2	10339	Spring	0	1	0	1
3	10338	Ball, Ceramic	2	4	3	4
4	10207	Seal Ring, Viton	2	4	3	4
5	10292	Valve Seat	1	2	1	2
6	10299	Coupling Nut	2	4	3	4
7	10342-16	Tubing	0	1	1	1
8	10293	Valve Housing	1	2	1	1
9	25960	Head	1	1	1	1
10	26041	Liquifram	1	1	1	1
11	10340	Screw, S.S.	4	4	4	4
12	10322	Weight, Ceramic	0	1	1	1
13	10978	Foot Valve Seat	0	1	1	1
14	10123	Strainer	0	1	1	1
15	10506	Injection Check/Back Pressure Valve	0	1	0	1
16	10507	Discharge Valve Ass'y	1	1	0	0
17	10508	Suction Valve Ass'y	1	1	1	1
18	10509	Foot Valve Ass'y	0	1	1	1
19	26113	Head Ass'y	1	1	0	0
19	26313	Head Ass'y	0	0	1	1
21	25690	Anti-Syphon/Pressure Release Ass'y	0	0	1	1
22	25691	Relief Cap Ass'y	0	0	1	1
23	25692	Anti-Syphon Cap Ass'y	0	0	1	1
24	25672	Screw	0	0	4	4
25	25449	Coupling Nut, Flapper	0	1	0	1
26	10290	Flapper, Viton	0	1	0	1
27	10294	Injector Fitting	0	1	0	1
35	25369	Valve Body	0	0	1	1
36	25628	Nut, S.S.	0	0	4	4
37	25631	Nut, Ferrule	0	0	1	1
38	25636-03	Tubing, Polyethylene, .25" O.D.	0	0	1	1
41	26136	Clamp Ring	2	3	2	3

*For Spare Parts Kit order Part No. SP-06.

See Reverse Side for Liquifram Installation Instructions

Z SERIES

Liquifram Removal & Installation

CHANGING LIQUIFRAM™

A. Make sure size code markings on top of spacer and replacement Liquifram™ are the same. Liquifram™ and spacer size code **must** match in order for pump to function. See Fig. 1.

Always wear protective clothing, gloves and face shield when working on or near chemical metering pumps.

B. Move foot valve from chemical solution into a container of water or appropriate flushing or neutralizing solution. Pump until head assembly is flushed then lift foot valve and continue pumping until air enters pump head. Remove pump head. If water or neutralizing solution cannot be pumped, remove head carefully and immerse in water or neutralizing solution.

C. Set stroke length knob to zero by rotating it counter-clockwise with the pump running. Then stop the pump by unplugging power cord.

D. Grasp outer edge of Liquifram™ with your fingers and rotate it counter-clockwise to unscrew it.

E. Before installing new Liquifram™, plug in pump and rotate stroke length control knob to zero (0). Screw in new Liquifram™ clockwise. Check Liquifram™ position with a pencil or similar straight edge held firmly against the spacer (take care **not** to scratch sealing flange of teflon-faced Liquifram™). Center of Liquifram™ should be flush with outer edges of spacer. See Fig. 2. Unplug pump. **Rotate stroke length knob to 100%** before installing head.

F. Reinstall pump head and tighten head mounting screws in criss-cross pattern. Do **not** overtighten.

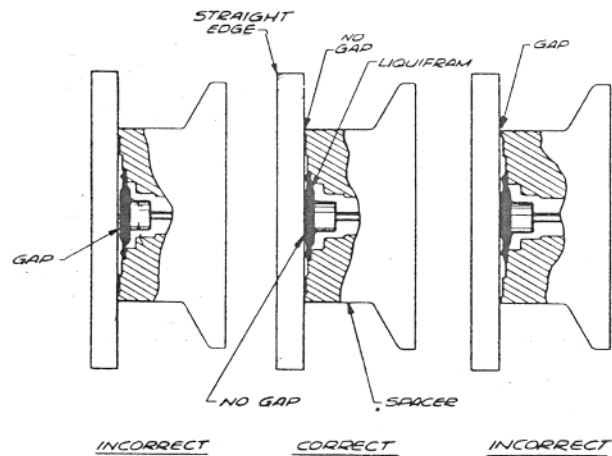
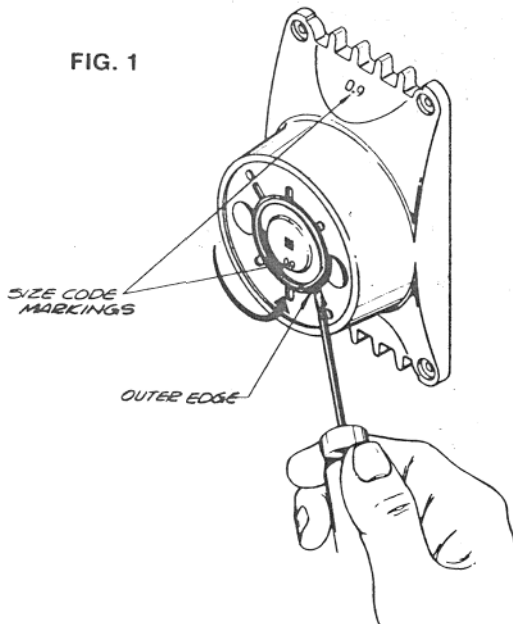

FIG. 2



LIQUID METRONICS INCORPORATED

19 CRAIG ROAD • ACTON, MA. 01720, U.S.A. • 617-263-9800 • TELEX 95-1781